

Soccer Field

**A**  
PARKING LOT

**D**  
PARKING LOT

ENTRANCE 50

LEE CENTER  
Margaret Burke Lee Science  
and Health-Careers Center

ENTRANCE 51

Outdoor Classroom

ENTRANCE 20

MAIN BUILDING

Receiving & Dock

ENTRANCE 5

ENTRANCE 1

**B**  
PARKING LOT  
Short term

ENTRANCE 37

**C**  
PARKING LOT

FACILITIES



NORTH

Rev. 12/23



To Golf Road (RT. 58)  
To Baseball and  
Softball Fields

Des Plaines Campus  
1600 E. Golf Road  
Des Plaines, IL 60016  
847.635.1600

Police Department  
847.635.1880 - Non-emergency  
847.635.1888 - Emergency  
oakton.edu

Find Your Path  
Oakton's Interactive Map

Use Now



NORTH

- Oakton Café**
- Elevator**
- Restrooms**

## Main Building

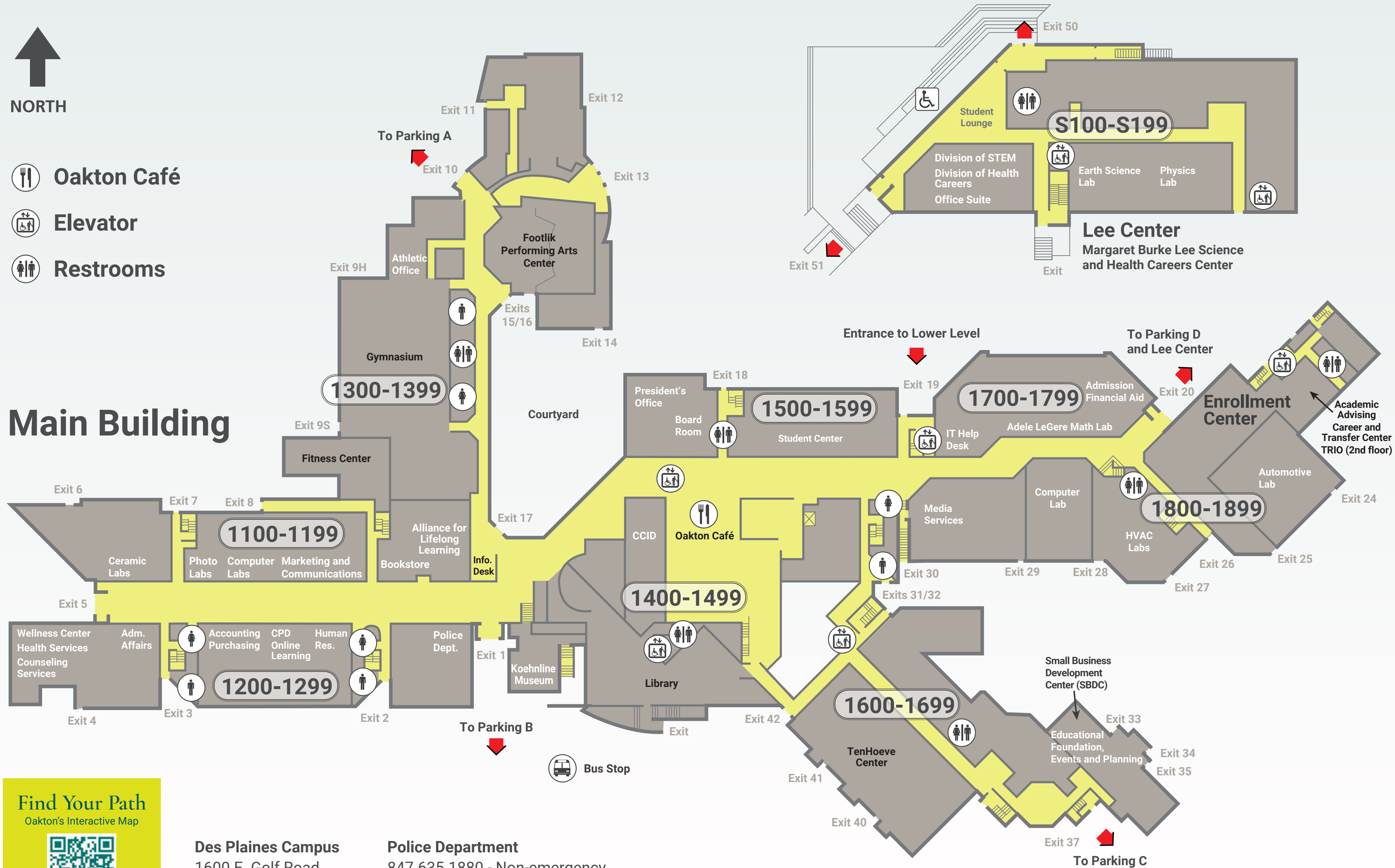

**Find Your Path**  
Oakton's Interactive Map

Use Now

**Des Plaines Campus**  
1600 E. Golf Road  
Des Plaines, IL 60016  
847.635.1600

**Police Department**  
847.635.1880 - Non-emergency  
847.635.1888 - Emergency  
[oakton.edu](http://oakton.edu)



NORTH



Elevator



Restrooms

## Main Building

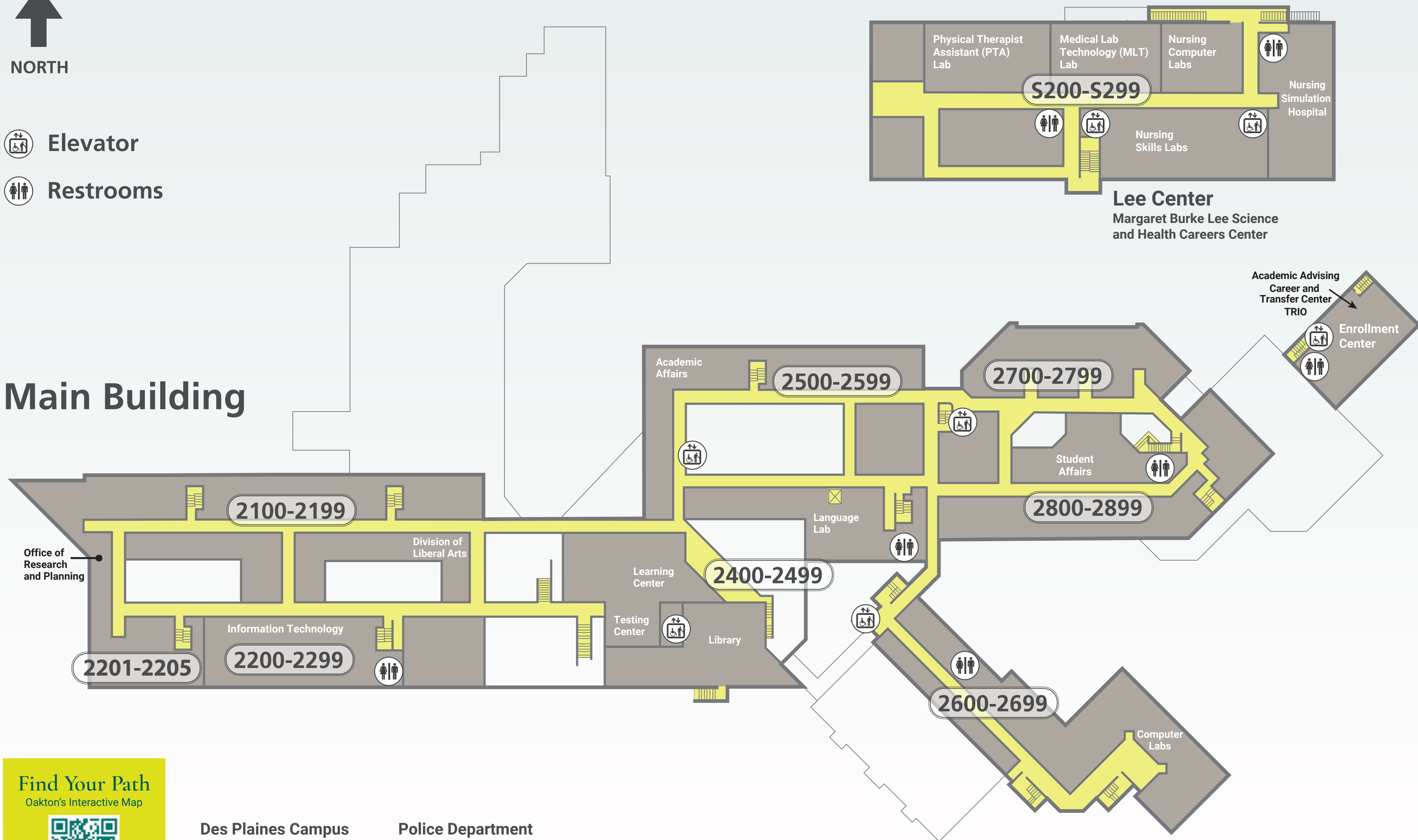

**Find Your Path**  
Oakton's Interactive Map

Use Now

**Des Plaines Campus**  
1600 E. Golf Road  
Des Plaines, IL 60016  
847.635.1600

**Police Department**  
847.635.1880 - Non-emergency  
847.635.1888 - Emergency  
[oakton.edu](http://oakton.edu)



NORTH



Elevator



Restrooms

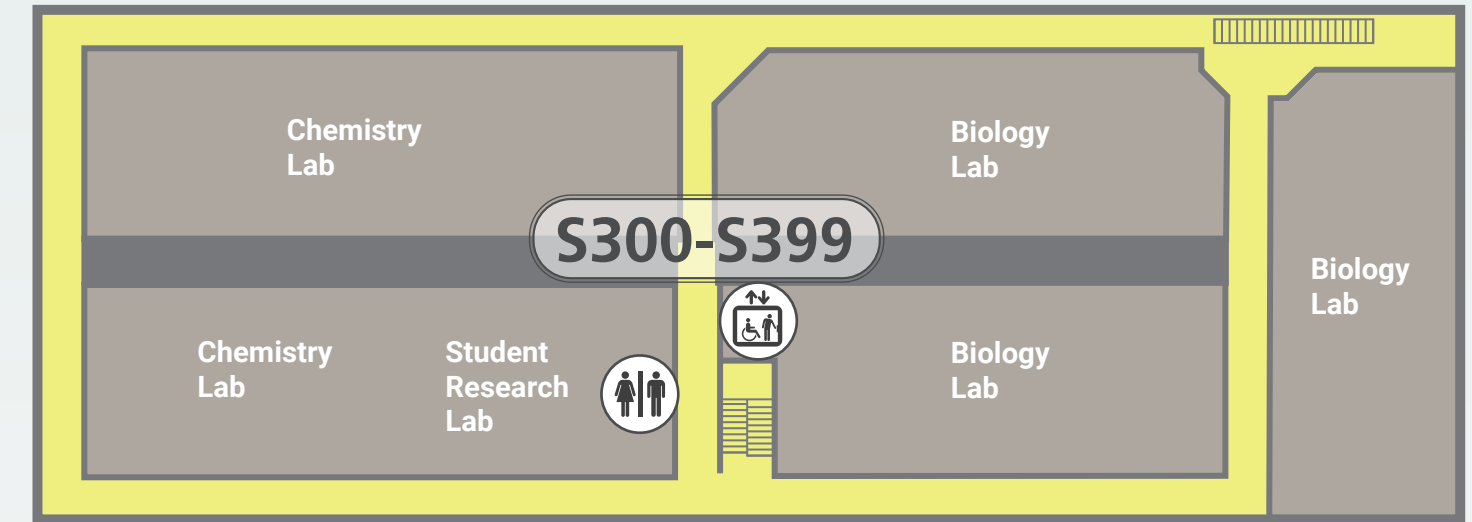

### Lee Center

Margaret Burke Lee Science  
and Health Careers Center

## Main Building

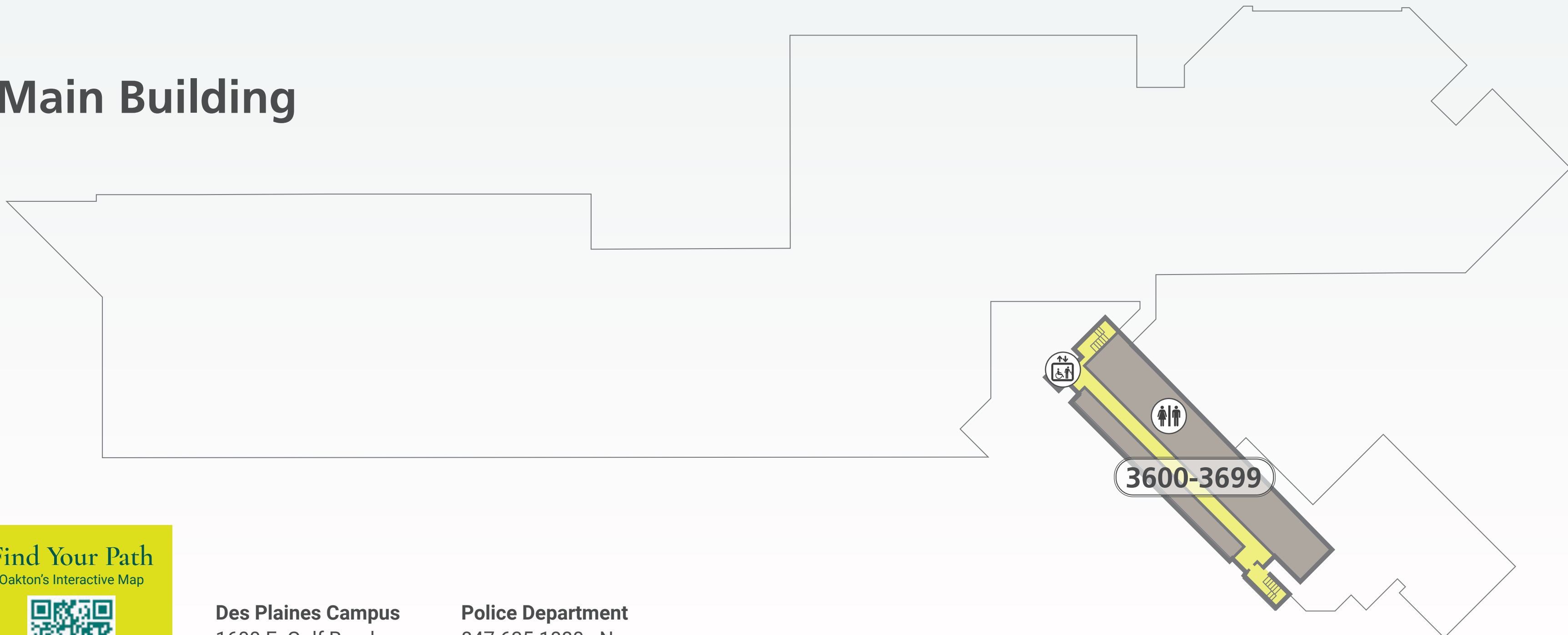

Find Your Path  
Oakton's Interactive Map



Use Now

**Des Plaines Campus**  
1600 E. Golf Road  
Des Plaines, IL 60016  
847.635.1600

**Police Department**  
847.635.1880 - Non-emergency  
847.635.1888 - Emergency  
[oakton.edu](http://oakton.edu)

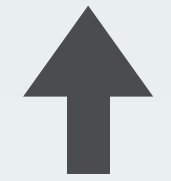

NORTH

Elevator

Restrooms

## Main Building

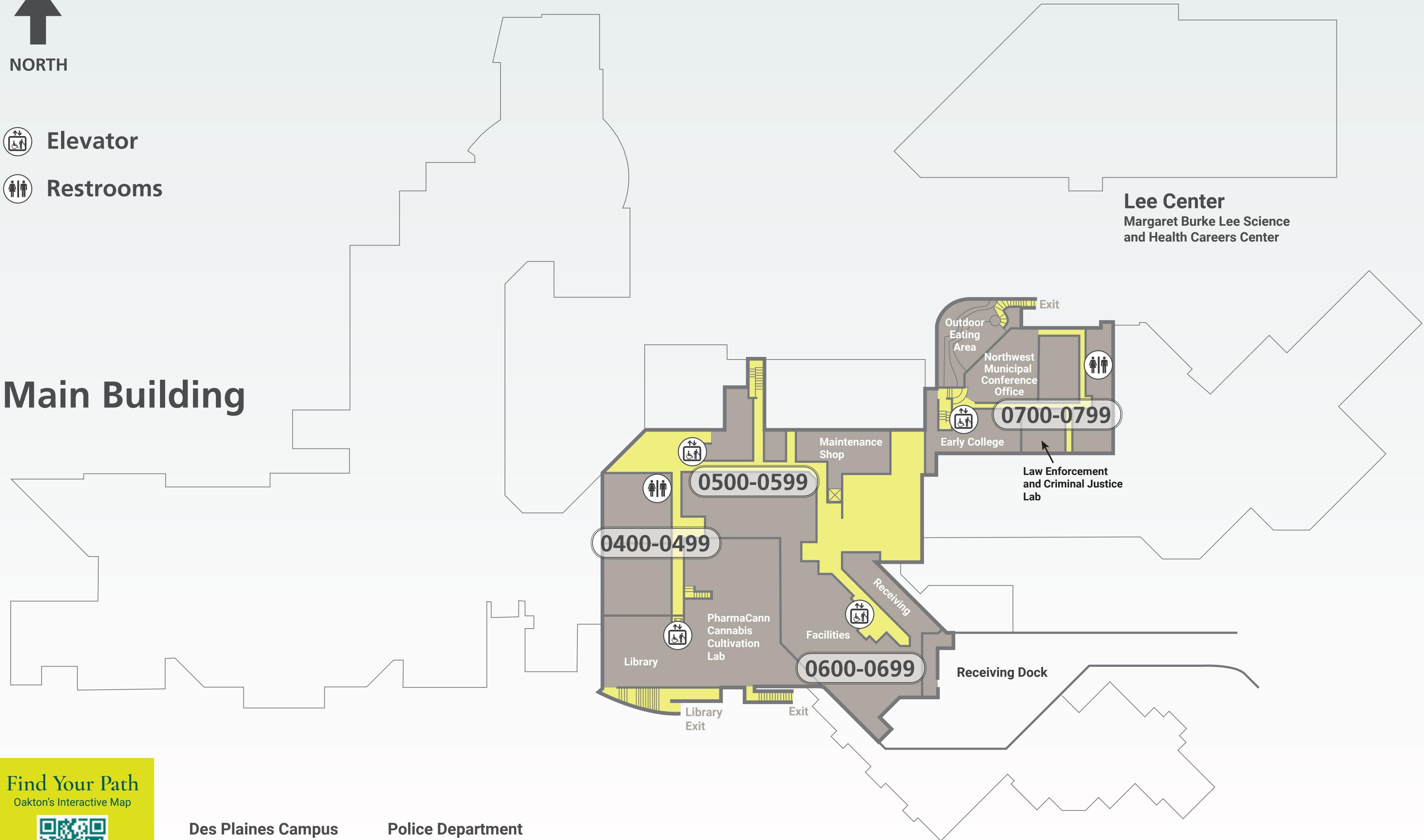

**Lee Center**  
Margaret Burke Lee Science  
and Health Careers Center

**Find Your Path**  
Oakton's Interactive Map



Use Now

**Des Plaines Campus**  
1600 E. Golf Road  
Des Plaines, IL 60016  
847.635.1600

**Police Department**  
847.635.1880 - Non-emergency  
847.635.1888 - Emergency  
[oakton.edu](http://oakton.edu)